

SAMSUNG

Samsung Air Conditioning





Air Conditioning Solutions from a Trusted Brand

At the heart of family living is the home, a place full of special moments and wonderful memories where families live and grow in their own unique way.

At Samsung, we imagine all sorts of innovative ways to improve how your home functions and help it run smoothly – so you have more quality time for the joys of raising your family and looking after their well-being.

We're proud to say our Samsung brand is recognised as one of the world's leading intuitive and humanistic product design companies, and one of the world's top electronics producers.

Samsung air conditioners have been designed with the same passion for innovation and quality that has helped make Samsung one of the 2011 Best Global Brands*.

Samsung air conditioning systems are held in high esteem around the world and have been selected for a multitude of developments including shopping centres, airports, stadiums and hotels.

Samsung continues to invest heavily in R&D, performance testing and quality control to deliver quality air conditioning systems to market.

2011 Best Global Brand

1. Coca Cola
2. IBM
3. Microsoft
- *
- *

17. SAMSUNG Electronics 

18. Louis Vuitton
- *
20. Oracle
- *
33. Canon
- *
35. Sony

*Source: Best Global Brand 2011. Interbrand.



Samsung Ducted Air Conditioning System

Working to keep you and your family comfortable all year round

A Samsung inverter reverse cycle ducted air conditioner enables each room in your home to be cooled or heated by one system. Ducted systems are also relatively unobtrusive as the conditioned air is distributed through ducts hidden in your roof space to outlets in the ceiling of each room.

The primary components of your Samsung ducted system consist of the indoor unit, outdoor unit and controller.

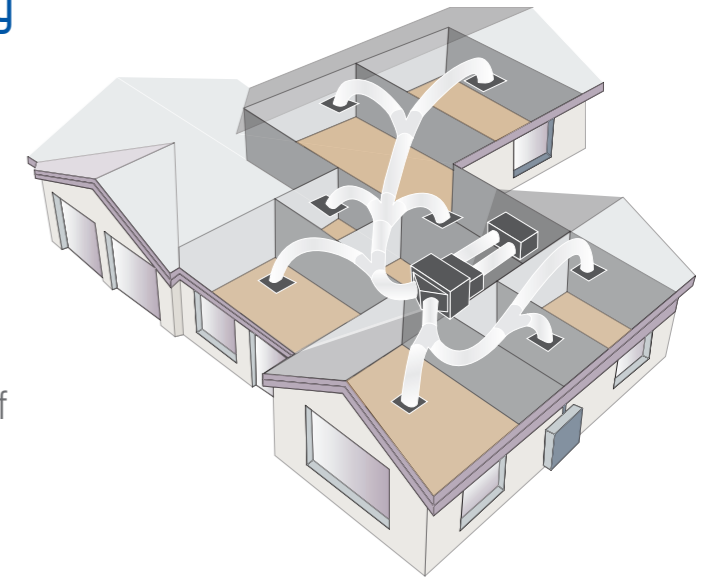

Controller

A stylish and intuitive controller makes it easy to select desired temperature and fan speeds. Premium controller models also include a number of advanced features such as LCD backlighting and time scheduling.



Outdoor Unit

The outdoor unit contains the Samsung Smart Inverter compressor which circulates refrigerant to the indoor unit and back again. The unit also contains a heat exchanging coil and a fan which blows air across the coil.



Indoor Unit

The indoor unit, hidden from view, also contains a heat exchanging coil that cools the air in your house in cooling mode and warms it in heating mode. A fan then blows the conditioned air through the ducts installed in your roof space to the outlets in the ceiling of each room.

Samsung Smart Inverter

Intelligent and Effective Air

Samsung's Smart Inverter technology maintains the ideal temperature without constantly shutting off and switching on the compressor. It automatically adjusts the capacity of the system to cope with any temperature variances, helping to ensure that you experience minimal temperature fluctuation for optimal comfort.

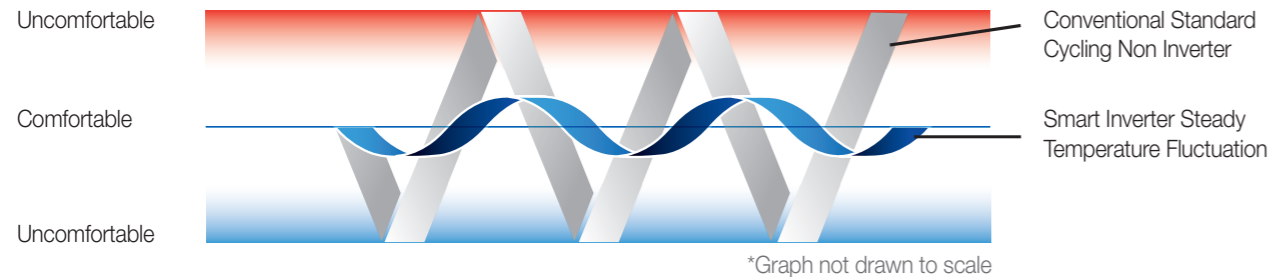

Comfortable, Reliable Air

Samsung ducted air conditioners are designed to keep on working, even on those extremely hot or cold days. With an operating range of -15°C to 50°C outside air temperature for cooling, and -20°C to 24°C for heating, you can rest assured that your unit will work when you need it the most.

*Whilst the unit will keep running up to 50°C for cooling, as the outside temperature rises above 35°C , the cooling capacity will reduce. Similarly for heating, the capacity begins to reduce below 7°C



Intuitive Control

Easy to Use and Stylish in Design

To accompany the ducted air conditioning system is a choice of controller. The Standard and Premium controllers are designed to match and enhance the look of your home.

Standard Controller Features

- **Quick-access on/off and temperature selection buttons**
- **On/off timer** allows the system to be started or stopped after a set time has passed
- **Built-in room temperature sensor**
- **Upper/Lower temperature limit setting** prevents temperature changes outside a set range
- **Automatic stop function** can set the unit to stop running after a set time has passed. This can help prevent the system being left on accidentally
- **Child lock**
- **Button permission levels**
- **Filter replacement alert**



Optional Premium Controller MWR-WE10 featured

Premium Controller Features

Includes all Standard Controller Features plus:

- **Clear and bright LCD Backlit Screen**
- **Real-time clock function**
- **Weekly operation scheduler** enables you to set your system to run automatically at certain times each day of the week



Samsung Ducted System Models and Specifications

Model Name	Indoor Unit		NS071SDXEA/XSA	NS100HHXEH/XSA	NS125HHXEH/XSA	NS140HHXEH/XSA	NS155HHXEH/XSA	NS180HHXEH/XSA	
	Outdoor Unit		RC071DHXEA/XSA	RC100DHXEH/XSA	RC125DHXEH/XSA	RC140DHXEH/XSA	RC155DHXEH/XSA	RC180DHXGH/XSA	
System									
Mode			Reverse Cycle	Reverse Cycle	Reverse Cycle	Reverse Cycle	Reverse Cycle	Reverse Cycle	
Capacity	Capacity (Nominal)	Cooling (Min / Std / Max)	kW	2.2 / 7.1 / 8.0	3.5 / 10.0 / 13.3	3.5 / 12.5 / 14.0	3.5 / 14.0 / 16.0	3.5 / 15.5 / 17.0	3.8 / 17.5 / 20.0
		Heating (Min / Std / Max)	kW	1.9 / 8.0 / 9.0	3.8 / 11.2 / 15.0	3.8 / 14.0 / 17.0	3.8 / 16.0 / 19.0	3.8 / 17.0 / 20.0	4.4 / 21.0 / 24.0
Power	Power Input (Nominal)	Cooling (Min / Std / Max)	kW	0.35 / 2.21 / 4.0	1.3 / 2.7 / 4.8	1.3 / 3.85 / 5.1	1.5 / 4.31 / 6.2	1.5 / 4.77 / 7.4	1.2 / 5.47 / 7.2
		Heating (Min / Std / Max)	kW	0.35 / 2.22 / 4.0	1.1 / 2.87 / 4.9	1.0 / 3.78 / 6.2	1.2 / 4.32 / 7.4	1.2 / 4.72 / 8.0	1.2 / 6.0 / 8.0
	Current Input (Nominal)	Cooling (Min / Std / Max)	A	2.0 / 10.5 / 21.0	6.5 / 12.2 / 20.7	6.5 / 17.0 / 22.5	7.0 / 19.0 / 28.0	7.0 / 21.5 / 32.0	2.6 / 9.1 / 11.3
		Heating (Min / Std / Max)	A	2.0 / 10.5 / 21.0	6.0 / 12.9 / 21.2	6.0 / 16.5 / 26.0	6.5 / 19.0 / 32.0	6.5 / 21.0 / 34.0	2.3 / 9.9 / 12.0
Circuit Breaker (MCCB+ELB / ELCB)			A	25	30	30	40	40	20
Energy Efficiency	AEER (Annual Energy Efficiency Ratio)		-	3.15	3.65	3.21	3.22	3.22	3.18
	ACOP (Annual Coefficient of Performance)		-	3.54	3.85	3.66	3.67	3.57	3.48
Piping Connections	Liquid Pipe		Φ, mm(inch)	6.35 (1/4)	9.52 (3/8)	9.52 (3/8)	9.52 (3/8)	9.52 (3/8)	9.52 (3/8)
	Gas Pipe		Φ, mm(inch)	15.88 (5/8)	19.05 (3/4)	19.05 (3/4)	19.05 (3/4)	19.05 (3/4)	19.05 (3/4)
	Installation Limitation	Max. Length (Outdoor to indoor)	m	50.0	75.0	75.0	75.0	75.0	75.0
		Max. Height (Between ID/OD)	m	30.0	30.0	30.0	30.0	30.0	30.0
Refrigerant	Type		-	R410A	R410A	R410A	R410A	R410A	R410A
	Factory Charging		kg	1.8 (Charged for 5m)	3.4 (Charged for 30m)	3.4 (Charged for 30m)	4.4 (Charged for 30m)	4.4 (Charged for 30m)	4.8 (Charged for 30m)
Indoor unit									
Power Supply			Φ, #, V, Hz	1, 2, 220~240, 50	1, 2, 220~240, 50	1, 2, 220~240, 50	1, 2, 220~240, 50	1, 2, 220~240, 50	1, 2, 220~240, 50
Fan	Type		-	Sirocco Fan	Sirocco Fan	Sirocco Fan	Sirocco Fan	Sirocco Fan	Sirocco Fan
	Air Flow Rate	High / Mid / Low	l/s	317 / 283 / 250	600 / 550 / 500	750 / 633 / 517	833 / 733 / 633	867 / 767 / 667	1,067 / 933 / 833
	External Static Pressure	Max / Std / Min	Pa	98.1 / 39.2 / 0	196 / 60 / 19	196 / 60 / 19	196 / 60 / 19	196 / 60 / 19	245 / 60 / 19
Sound	Sound Pressure	High / Mid / Low	dB(A)	39 / 35	46 / 40.5 / 35	48 / 42.5 / 37	50 / 44.5 / 39	51 / 46 / 41	52 / 46 / 44
Plenum Size	Supply Air Spigot (WxH)		mm	904 x 185	1000 x 253	1000 x 253	1000 x 253	1000 x 253	1188 x 385
	Return Air Spigot (WxH)		mm	985 x 178*	1160 x 276	1160 x 276	1160 x 276	1160 x 276	1188 x 385
External Dimension	Net Weight		kg	33	58.0	60.0	60.0	60.0	95.0
	Shipping Weight		kg	40	67.5	69.5	69.5	69.5	105.0
	Net Dimensions (WxHxD)		mm	1,150 x 260 x 480	1,200 x 360 x 650	1,200 x 360 x 650	1,200 x 360 x 650	1,200 x 360 x 650	1,240 x 470 x 1,040
	Shipping Dimensions (WxHxD)		mm	1,405 x 354 x 593	1,447 x 425 x 769	1,447 x 425 x 769	1,447 x 425 x 769	1,447 x 425 x 769	1,507 x 558 x 1,155
Outdoor unit									
Power Supply			Φ, #, V, Hz	1, 2, 220~240, 50	1, 2, 220~240, 50	1, 2, 220~240, 50	1, 2, 220~240, 50	1, 2, 220~240, 50	3, 4, 380~415, 50
Compressor	Type		-	Twin BLDC Rotary	Twin BLDC Rotary	Twin BLDC Rotary	Twin BLDC Rotary	Twin BLDC Rotary	Twin BLDC Rotary
Fan	Air Flow Rate	Cooling / Heating	l/s	833 / 800	1,508 / 1,508	1,508 / 1,508	1,683 / 1,683	1,683 / 1,683	2,150 / 2,150
Sound	Sound Pressure	Cooling / Heating	dB(A)	49 / 51	50 / 52	51 / 53	52 / 54	53 / 55	55 / 57
External Dimension	Net Weight		kg	55	88.0	88.0	99.0	99.0	102.0
	Shipping Weight		kg	59	98.0	98.0	109.0	109.0	111.0
	Net Dimensions (WxHxD)		mm	880 x 798 x 310	940 x 1,210 x 330	940 x 1,210 x 330	940 x 1,420 x 330	940 x 1,420 x 330	940 x 1,420 x 330
	Shipping Dimensions (WxHxD)		mm	1,023 x 889 x 416	995 x 1,338 x 426	995 x 1,338 x 426	995 x 1,548 x 426	995 x 1,548 x 426	995 x 1,548 x 426
Operating Temp. Range	Cooling	°C	-15 ~ 50	-15 ~ 50	-15 ~ 50	-15 ~ 50	-15 ~ 50	-15 ~ 50	
	Heating	°C	-20 ~ 24	-20 ~ 24	-20 ~ 24	-20 ~ 24	-20 ~ 24	-20 ~ 24	

* Specifications may be subject to change without prior notice for product improvement.

*1) Nominal cooling capacities are based on;

- Indoor temperature: 27°C DB, 19°C WB / Outdoor temperature: 35°C DB, 24°C WB
- Equivalent refrigerant piping: 7.5m , Level differences: 0m

*2) Nominal heating capacities are based on;

- Indoor temperature: 20°C DB, 15°C WB / Outdoor temperature: 7°C DB, 6°C WB
- Equivalent refrigerant piping: 7.5m , Level differences: 0m

*3) Sound pressure was acquired in a dead room. Thus actual noise level may be different depending on the installation conditions.

*4) NS071SDXEA/XSA return air flange not supplied. Dimension shown in above table is the opening size.



Samsung 4-Way Cassette S provides stylish design and year round comfort

Stylish design, an effective Smart Inverter compressor and a plethora of innovative features make the new Samsung 4-Way Cassette S ideal for residential and light commercial applications with limited roof space.

Stylish Panel Design

The new waffle pattern delivers a stylish design with a subtle fascia panel to compliment the aesthetics of any interior space.



Waffle Pattern

Smart Inverter Compressor

Samsung's Smart Inverter technology maintains the ideal temperature without constantly shutting off and switching on the compressor. It automatically adjusts the capacity of the system to cope with any temperature variances, helping to ensure that you experience minimal temperature fluctuation for optimal comfort.

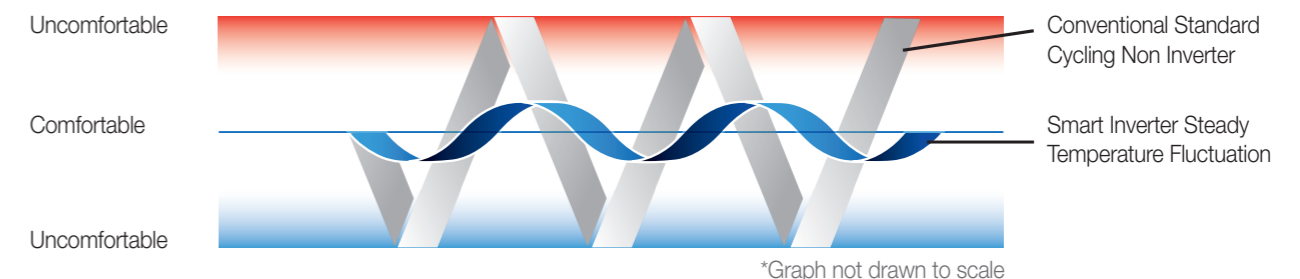

Wide Temperature Performance Range

The 4-Way Cassette S is designed with an operating range of -15°C to 50°C outside air temperature for cooling, and -20°C to 24°C for heating. You can rest assured that your unit will work when you need it the most.

*Whilst the unit will keep running up to 50°C for cooling, as the outside temperature rises above 35°C, the cooling capacity will reduce. Similarly for heating, the capacity begins to reduce below 7°C





Samsung 4-Way Cassette S

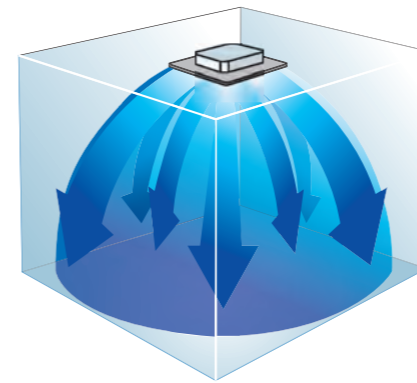

More uniform airflow

The blades have angled sections to guide air 'around the corner'. This helps to reduce the 'blind spot' effect of the corners giving more uniform airflow.

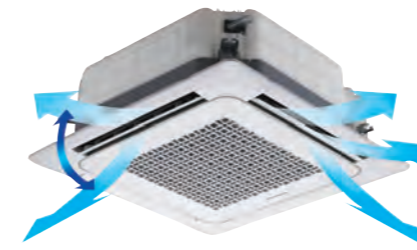

Customisable air flow

The unit can be configured as a 4, 3, 2 or even 1 way cassette by selecting which blades are open when the unit is running. Vertical blade angles can be individually set for optimum airflow in your home.



Easy to clean

Airflow blades can be easily removed individually for cleaning so you don't need to remove the whole panel.



Control options

Select from a wired or wireless infra red remote controller.

Premium Controller Features

Includes all Standard Controller Features (see page 7) plus:

- **Clear and bright LCD Backlit Screen**
- **Real-time clock function**
- **Weekly operation scheduler** enables you to set your system to run automatically at certain times each day of the week

4-Way Cassette S System Models and Specifications

Model Name	Indoor Unit			NS0714PXEA/XSA	NS1004PXEA/XSA	NS1254PXEA/XSA	NS1404PXEA/XSA
	Outdoor Unit			RC071PHXEA/XSA	RC100PHXEA/XSA	RC125PHXEA/XSA	RC140PHXEA/XSA
System							
Mode				Reverse Cycle	Reverse Cycle	Reverse Cycle	Reverse Cycle
Capacity	Capacity (Nominal)	Cooling (Min / Std / Max)	kW	2.2 / 7.1 / 8.0	3.5 / 10.0 / 12.0	3.5 / 12.5 / 14.0	4.4 / 14.0 / 15.5
		Heating (Min / Std / Max)	kW	1.9 / 8.0 / 9.0	3.5 / 11.2 / 15.5	3.5 / 14.0 / 16.2	3.5 / 16.0 / 20.0
Energy Efficiency	AEER (Annual Energy Efficiency Ratio)			3.49	3.99	3.39	3.30
	ACOP (Annual Coefficient of Performance)			3.90	4.29	3.70	3.70
Power	Power Input (Nominal)	Cooling (Min / Std / Max)	kW	0.35 / 2.03 / 4.00	0.8 / 2.5 / 3.8	0.8 / 3.68 / 4.8	1.05 / 4.24 / 5.4
		Heating (Min / Std / Max)	kW	0.35 / 2.05 / 4.00	0.7 / 2.61 / 4.5	0.7 / 3.78 / 4.5	0.87 / 4.32 / 6.5
	Current Input (Nominal)	Cooling (Min / Std / Max)	A	2.1 / 9.5 / 18.0	3.7 / 10.5 / 24.0	3.7 / 15.5 / 24.0	4.6 / 17.8 / 24.0
		Heating (Min / Std / Max)	A	2.1 / 9.5 / 18.0	3.5 / 11.5 / 24.0	3.5 / 16.0 / 24.0	4.0 / 18.7 / 28.0
	Circuit Breaker (MCCB+ELB / ELCB)			A	25	30	30
Piping Connections	Liquid Pipe	Φ, mm(inch)		6.35 (1/4)	9.52 (3/8)	9.52 (3/8)	9.52 (3/8)
	Gas Pipe	Φ, mm(inch)		15.88 (5/8)	15.88 (5/8)	15.88 (5/8)	15.88 (5/8)
	Installation Limitation	Max. Length	m	50.0	75.0	75.0	75.0
		Max. Height	m	30.0	30.0	30.0	30.0
Refrigerant	Type	-			R410A	R410A	R410A
	Factory Charging	kg		1.8 (Charged for 5m)	3.4 (Charged for 30m)	3.4 (Charged for 30m)	3.8 (Charged for 30m)
Indoor unit							
Power Supply	Φ, #, V, Hz			1, 2, 220~240, 50	1, 2, 220~240, 50	1, 2, 220~240, 50	1, 2, 220~240, 50
Fan	Type	-			Turbo Fan / BLDC	Turbo Fan / BLDC	Turbo Fan / BLDC
	Air Flow Rate	High / Mid / Low	ℓ/s	(C) 383 / 350 / 292 (H) 367 / 300 / 267	500 / 400 / 300	500 / 400 / 317	533 / 433 / 350
Sound	Sound Pressure	High / Mid / Low	dB(A)	36 / 32 / 28	44 / 39 / 34	44 / 40 / 36	45 / 41.5 / 38
External Dimension	Net Weight			kg	17	21	21
	Shipping Weight			kg	22	26	26
	Net Dimensions (WxHxD)			mm	840 x 246 x 840	840 x 288 x 840	840 x 288 x 840
	Shipping Dimensions (WxHxD)			mm	898 x 316 x 898	898 x 357 x 898	898 x 357 x 898
	Panel model			-	PC4NUSKA / PC4NUSKE	PC4NUSKA / PC4NUSKE	PC4NUSKA / PC4NUSKE
Panel Size	Panel Net Weight			kg	5.9	5.9	5.9
	Shipping Weight			kg	8.4	8.4	8.4
	Net Dimensions (WxHxD)			mm	950 x 45 x 950	950 x 45 x 950	950 x 45 x 950
	Shipping Dimensions (WxHxD)			mm	1,005 x 100 x 1,005	1,005 x 100 x 1,005	1,005 x 100 x 1,005
	Accessories	Drain pump	Drain pump	-	Built-in	Built-in	Built-in
Max. Lifting Height / Displacement			mm / ℓ/h	750 / 24	750 / 24	750 / 24	750 / 24
Air Filter			-	Long life filter	Long life filter	Long life filter	
Outdoor unit							
Power Supply	Φ, #, V, Hz			1, 2, 220~240, 50	1, 2, 220~240, 50	1, 2, 220~240, 50	1, 2, 220~240, 50
Compressor	Type	-			Twin BLDC Rotary	Twin BLDC Rotary	Twin BLDC Rotary
Fan	Air Flow Rate	Cooling / Heating	ℓ/s	833 / 800	1,508 / 1,383	1,508 / 1,508	1,683 / 1,683
Sound	Sound Pressure	Cooling / Heating	dB(A)	49 / 51	49 / 51	51 / 52	51 / 53
External Dimension	Net Weight			kg	55	88	98
	Shipping Weight			kg	59	98	108
	Net Dimensions (WxHxD)			mm	880 x 798 x 310	940 x 1,210 x 330	940 x 1,210 x 330
	Shipping Dimensions (WxHxD)			mm	1,023 x 889 x 416	995 x 1,338 x 426	995 x 1,338 x 426
Operating Temp. Range	Cooling			°C	-15 ~ 50	-15 ~ 50	-15 ~ 50
	Heating			°C	-20 ~ 24	-20 ~ 24	-20 ~ 24

* Specifications may be subject to change without prior notice for product improvement.

*1) Nominal cooling capacities are based on;
 - Indoor temperature: 27°C DB, 19°C WB
 - Outdoor temperature: 35°C DB, 24°C WB
 - Equivalent refrigerant piping: 5m , Level differences: 0m

*2) Nominal heating capacities are based on;
 - Indoor temperature: 20°C DB, 15°C WB
 - Outdoor temperature: 7°C DB, 6°C WB
 - Equivalent refrigerant piping: 5m , Level differences: 0m

*3) Sound pressure was acquired in a dead room.
 Thus actual noise level may be different depending on the installation conditions.



Wall Mounted Inverter Split Systems

Samsung's new range of Max Plus inverter split systems provide year round comfort for both summer and winter while offering great air quality. Included in the new line-up is the introduction of an Ionizer, Quiet Mode and a host of features.



Good Sleep Mode automatically adjusts the temperature to create the most ideal temperature which may help you fall asleep, maintain a comfortable sleep environment and awake refreshed.



New HD80 filtration can help reduce dust in the air.



Smart Mode enables the air conditioner's compressor to operate at a reduced intensity when the air conditioner is not required to be run at maximum cooling / heating capacity.



Turbo Cooling Mode operates the unit at its maximum speed to quickly reach the set temperature.

Model			AQV09UWLNXSA	AQV12UWLNXSA	AQV18UWLNXSA	AQV24UWCNXSA	AQV30UWCNXSA
Capacity	Cooling	kW	2.5	3.5	5.0	6.8	8.0
		(min-max)	0.99-3.20	0.99-4.00	1.60-6.00	2.20-8.00	2.00-9.3
	Heating	kW	3.2	4.0	6.0	8.0	9.0
		(min-max)	0.99-5.20	0.99-6.00	1.20-8.00	1.90-10.00	2.20-12.0
Energy Efficiency	Cooling	AEER(W/W)	4.34	3.80	3.53	3.42	3.35
	Heating	ACOP(W/W)	4.52	4.04	3.53	3.35	3.40
	Cooling	Stars	4.0	3.0	2.5	2.0	2.0
	Heating	Stars	4.5	3.5	2.5	2.0	2.0
Moisture Removal		ℓ/hr.	1.0	1.4	2.5	3.0	4.5
Air Circulation (Max)		l/Sec	190	200	275	320	430
Noise Level	Indoor High	dB	35	36	40	41	45
	Indoor Low(±3)	dB	20	20	27	27	29
	Outdoor High	dB	45	47	53	55	57
Dimension	Indoor	mm	890 x 285 x 190	890 x 285 x 190	1065 x 298 x 230	1065 x 298 x 230	1279 x 345 x 229
	Outdoor	mm	790 x 548 x 285	790 x 548 x 285	880 x 638 x 310	880 x 798 x 310	880 x 798 x 310
Weight	Indoor	kg	8.6	8.6	11.4	11.4	18.2
	Outdoor	kg	36	36	52	54.2	62.0
Operating Range	Cooling	C°			-10 ~ 46		
	Heating	C°			-15 ~ 24		

* Ionizer included in all models except AQV30UWCNXSA



Samsung Air Conditioning Committed to After Sales and Warranty Support

Peace Of Mind

Rest assured that you are buying a quality air conditioner with Samsung's 5 year parts and labour warranty on products featured in this brochure. Refer to the warranty card included with your product for full details.



Product Support Line

If you have any concerns about your product simply call 1300 362 603 and our friendly staff will assist with your enquiry and book a service call if required.



National Samsung Service Network

Our national network of Authorised Service Centres and Customer Service Plazas are on hand to support your product. Our specialist technicians will provide a fast and effective response.

MEPS Compliant

Air conditioners sold in Australia are required to meet Minimum Energy Performance Standards (MEPS) set by the Government.

These standards are based on the ratio of a system's energy input versus its capacity.

On the 1st of October 2011 the latest minimum efficiency levels came into effect. Samsung is proud to state that our latest inverter ducted, 4 way cassette and wall hung split systems are fully compliant with these MEPS levels.



Learn more about
Samsung Air Conditioning at
www.samsung.com.au

